

UCBW

止推垫圈 Thrust washers



●能与UCB050组合使用。

请从适用的内径、外径、长度中选择零件号
(例)内径30.2mm、厚度5mm的情况下

UCBW - 3005

请指定上述零件号

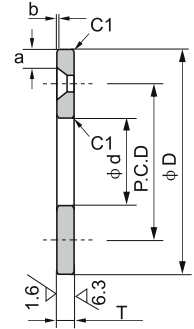
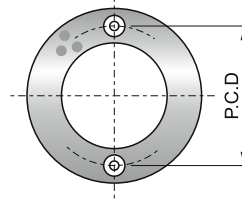
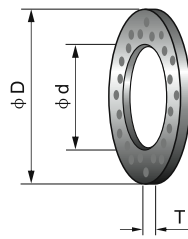

a b : 端面倒角 (mm)

∅d	~ 10.2	~ 18.2	~ 35.2	~ 45.2	~ 55.3	~ 100.5	~ 120.5
a	1.5	2	2.5	3	4	5	4
b	0.3	0.4	0.4	0.5	0.6	0.8	0.8

Parts No.	内径		外径	厚度		定位孔		
	∅d		∅D	T		P.C.D	个数	定位螺栓
UCBW-0603	6.2	^{+0.2} / _{+0.1}	25	3	⁰ / _{-0.1}	15	2	M3
UCBW-0803	8.2	"	28	"	"	18	"	"
UCBW-1003	10.2	"	30	"	"	20	"	"
UCBW-1203	12.2	"	40	"	"	28	"	"
UCBW-1203N	"	"	"	"	"	无定位孔		
UCBW-1303	13.2	"	"	"	"	28	2	M3
UCBW-1403	14.2	"	"	"	"	"	"	"
UCBW-1503	15.2	"	50	"	"	35	"	"
UCBW-1603	16.2	"	"	"	"	"	"	"
UCBW-1603N	"	"	"	"	"	无定位孔		
UCBW-1803	18.2	"	"	"	"	35	2	M3
UCBW-2005	20.2	"	"	5	"	"	"	M5
UCBW-2505	25.2	"	55	"	"	40	"	"
UCBW-2505N	"	"	"	"	"	无定位孔		
UCBW-3005	30.2	"	60	"	"	45	2	M5
UCBW-3005N	"	"	"	"	"	无定位孔		
UCBW-3505	35.2	"	70	"	"	50	2	M5
UCBW-4007	40.2	^{+0.2} / _{+0.1}	80	7	⁰ / _{-0.1}	60	2	M6
UCBW-4507	45.2	"	90	"	"	70	"	"
UCBW-5008	50.3	^{+0.3} / _{+0.1}	100	8	"	75	4	"
UCBW-5508	55.3	"	110	"	"	85	"	"
UCBW-6008	60.3	"	120	"	"	90	"	M8
UCBW-6508	65.3	"	125	"	"	95	"	"
UCBW-7010	70.3	"	130	10	"	100	"	"
UCBW-7510	75.3	"	140	"	"	110	"	"
UCBW-8010	80.3	"	150	"	"	120	"	"
UCBW-9010	90.5	"	170	"	"	140	"	M10
UCBW-10010	100.5	"	190	"	"	160	"	"
UCBW-12010	120.5	"	200	"	"	175	"	"